



FlashForge

ADVENTURER 3

ABC3D

Quick Start Guide

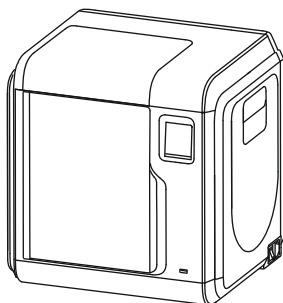

⚠ WARNING

1. Hot! Avoid touching the heating nozzle and heating build plate in operation.
2. Moving parts in printer may cause injury. Do not wear gloves or other sources of entanglement in operation.

Download

Please refer to FlashForge official website to download the newest User's Guide, Software and Instruction Videos.
(Support-Support Centre-Select Product) www.flashforge.com.

This guide is only for 3D printer FLASHFORGE Adventurer3 which was purchased in the Czech and Slovakia region in partner network Abc3D. Partners Abc3D are ready to offer best technical service and support.

Consumables, accessories Adventurer3 and nearest service you can find

[Consumables & accessories](#)

www.Abc3D.cz/kontakty

Kit Contents

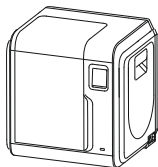

3DPrinter



Filament



Power Cable



After-sales
service card



Quick Start Guide



Screwdriver

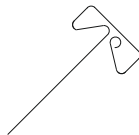

Unclogging Pin Tool



Allen Wrench

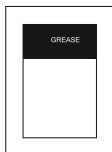

Grease

Getting to know your Adventurer 3

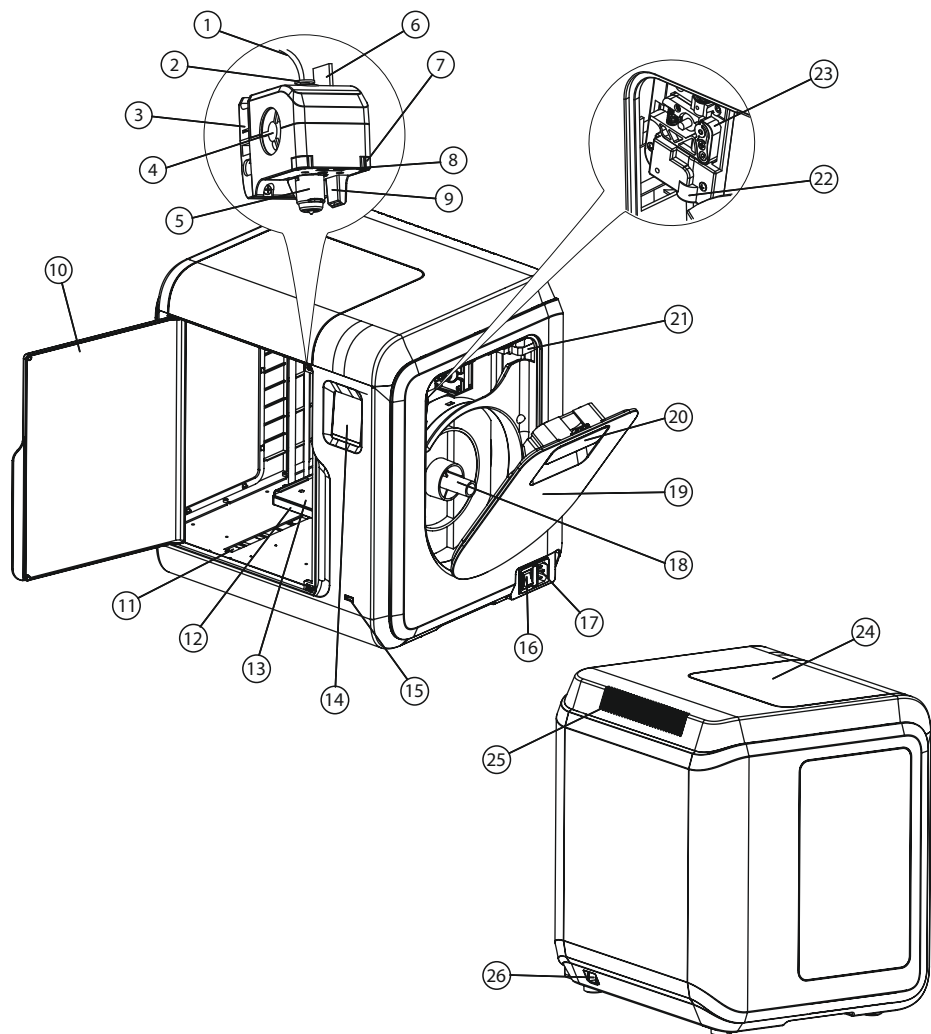

- | | | | |
|---------------------------|------------------------------|----------------------------|---------------------------|
| 1. Filament guide tube | 2. Filament guide tube joint | 3. Extruder base | 4. Cooling Fan |
| 5. Removable nozzle | 6. Extruder cables | 7. Clip | 8. Led light |
| 9. Wind guide nose | 10. Front door | 11. Y-Axis sliding slot | 12. Platform base |
| 13. Removable build plate | 14. Touch-screen | 15. USB stick input | 16. Power switch |
| 17. Power input | 18. Spool holder | 19. Filament cover | 20. Filament cover handle |
| 21. Moto | 22. Filament intake | 23. Filament feeding wheel | 24. Top cover |
| 25. Air outlet | 26. Ethernet input | | |

Unpacking

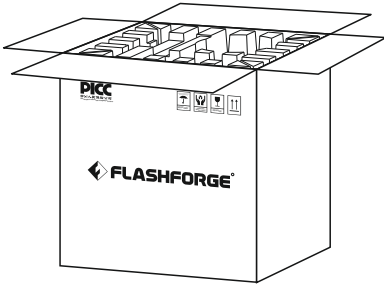

1. Open the box.

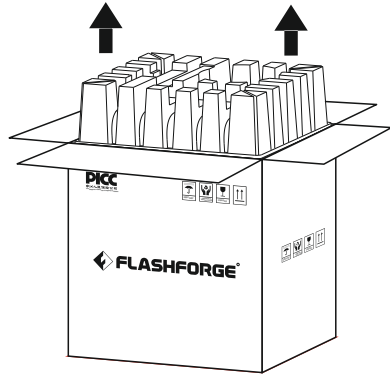

2. Take out the wrapping paper box on the top.

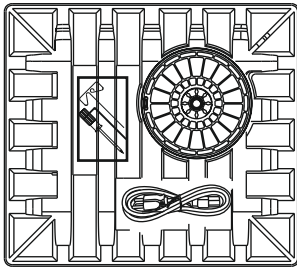

3. Be careful! Filament, tools kit and power cable are all placed inside the wrapping paper box.

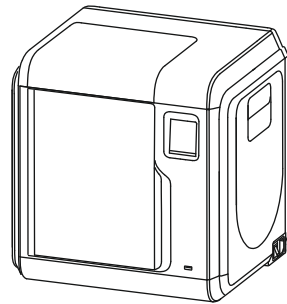

4. Take out the printer from the box.

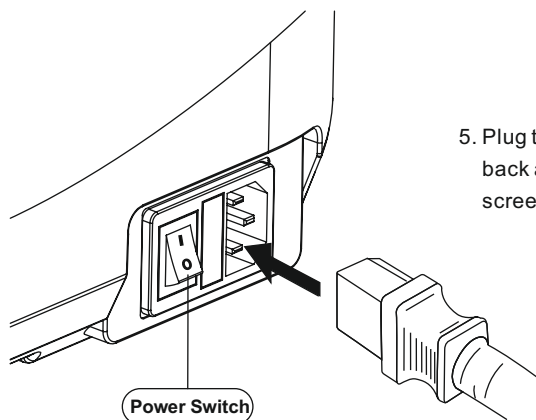

5. Plug the power cable into the input on the back and turn on the power switch, the touch screen is turned on.

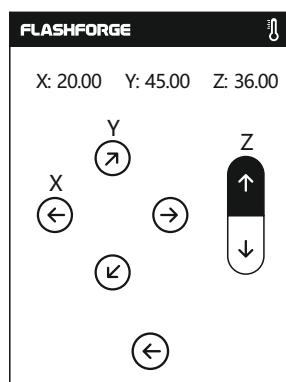
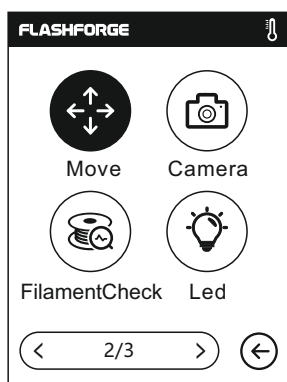
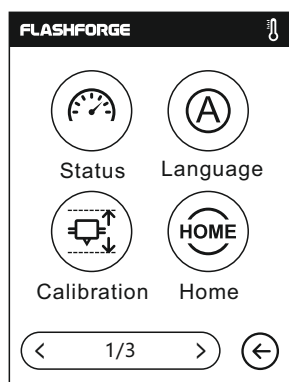

6. Click [tools]-[setting] in turn to enter page like this, turn to page two, click [move]. Click the upper arrow in the moving page to make the extruder raises for removing the paper box on the bottom easier.

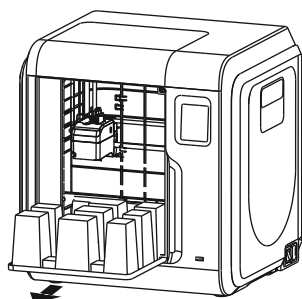

7. Open the front door, take out the paper box inside the printer, printer unpacking completed.

First Print

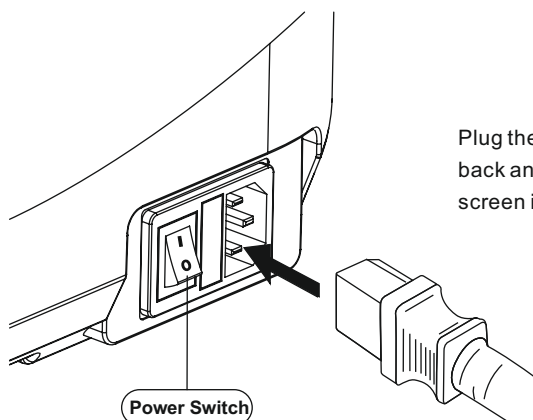

Plug the power cable into the input on the back and turn on the power switch, the touch screen is turned on.

Load Filament

1. Open the filament cover, insert the filament into the filament intake, push filament into the feeding wheel until some resistance is sensed.

Note: Please make sure filament has been pushed into the feeding wheel!

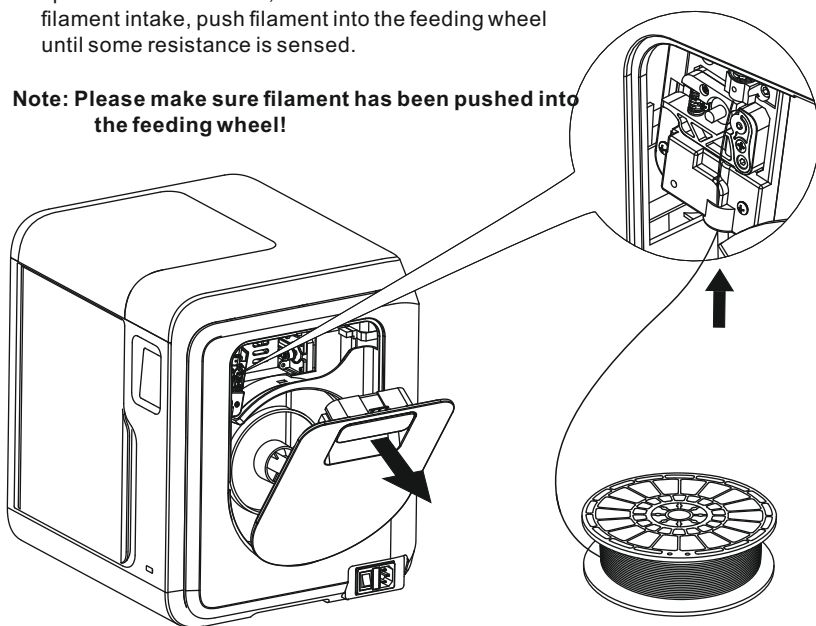

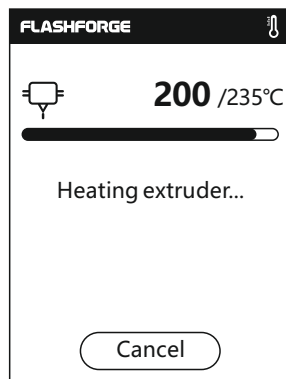
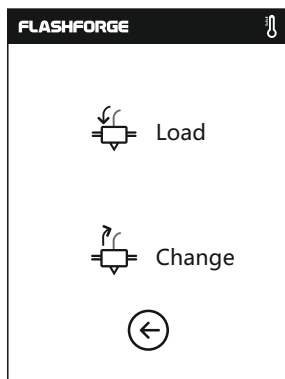
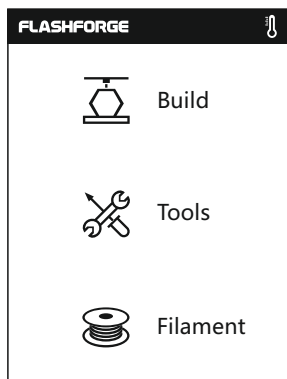

2. Tap [Filament]--Tap [Load]--After Load completed--Tap [OK]

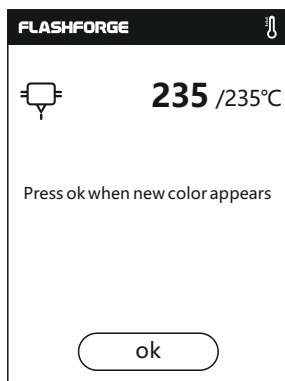
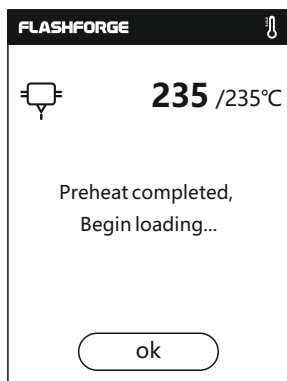

3. Load completed when you see filament come out of extruder, Tap [OK].

Put the spool of filament on the spool holder, close the filament cover.

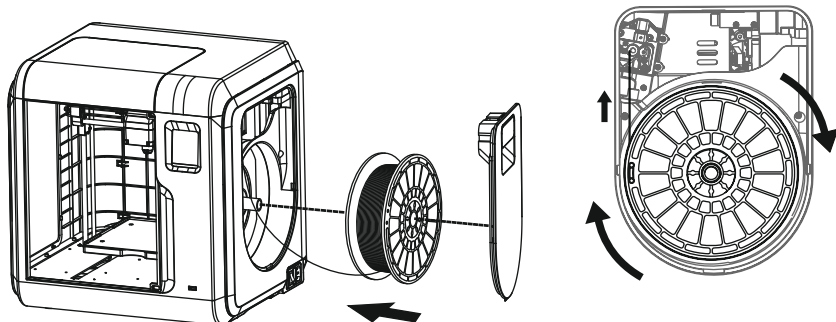

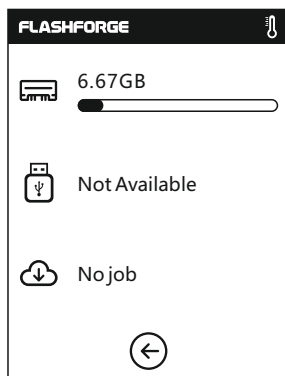
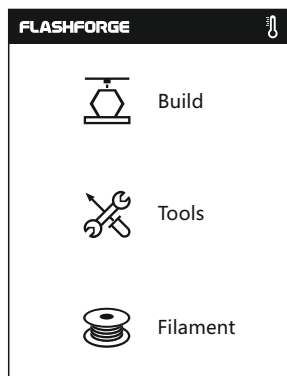

Mind the loading direction of filament, make sure to be clockwise as the picture showed.

Model Print

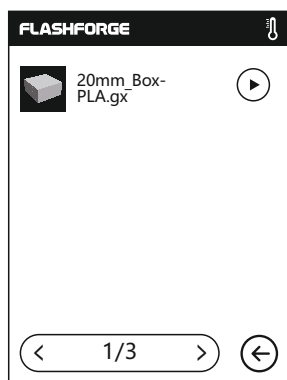

1. Tap [Build], choose the file path: Print from local memory card. 

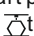

2. Locate the model file  in the model list, Tap  on its right to start printing; or tap model file picture or file name to enter model details page, tap  to start printing.

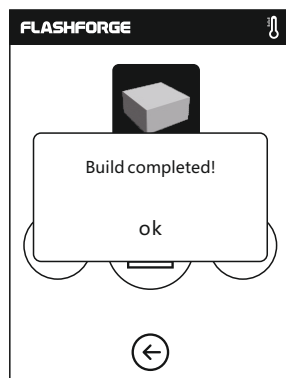
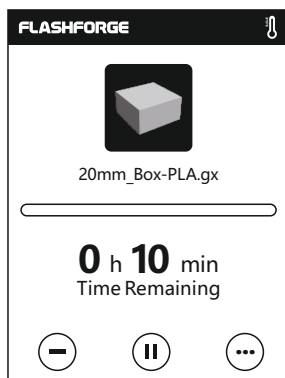
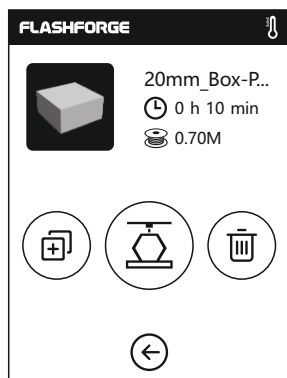

3. Extruder will heat up and printer will start printing after heating completed. After model printing finished, printer will sound a beep and pop out notice on touch screen.

Model Remove

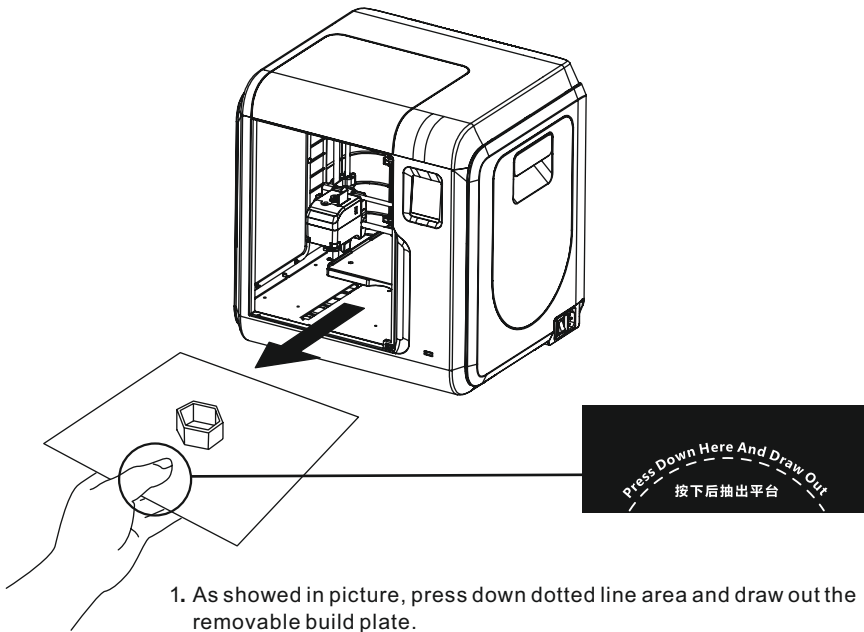

⚠ Notices

When printing completed, extruder and build plate may still hot, please start operating after cooling down!

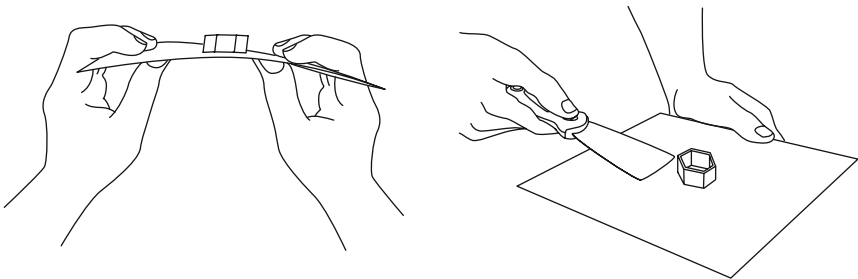

Change Filament

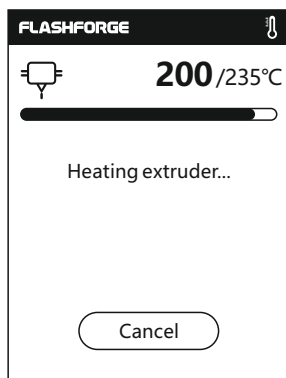
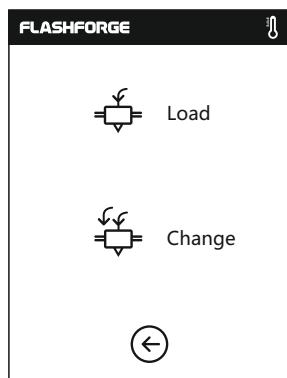

1. Tap [Filament]--Tap [Change], extruder will start preheating.

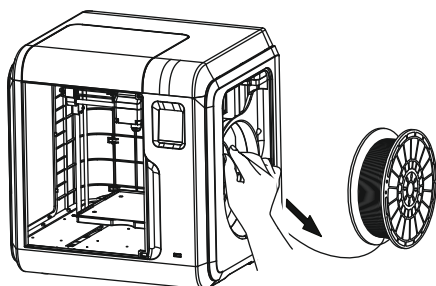

2. Pull out the filament as the picture showed above.

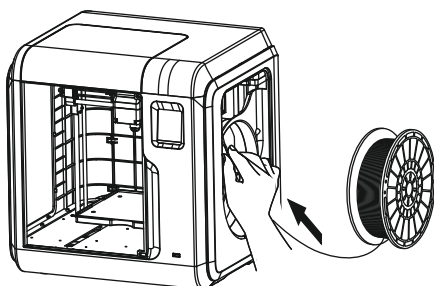

3. Insert new filament into the filament intake and push the filament into the feeding wheel until resistance is sensed.

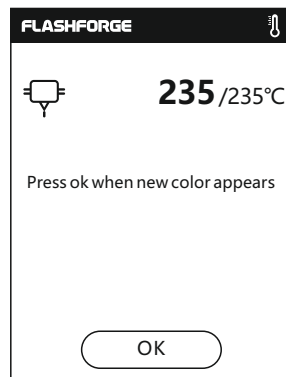
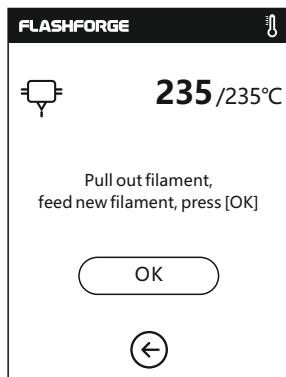
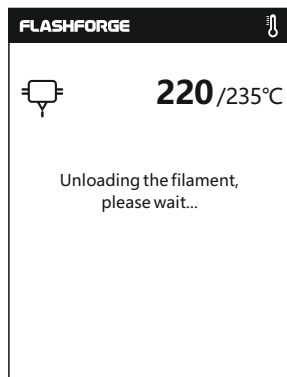

4. When new filament come out of extruder steadily, replace is completed, Tap [OK].